

- NOTES:**
1. ALL DIMENSIONS IN METRES (M) UNLESS NOTED OTHERWISE.
  2. DO NOT SCALE FROM THIS DRAWING. USE FIGURED DIMENSIONS ONLY.
  3. ALL HYDRANTS ARE TO BE IN BOXES TO B.S. 750 AND THE TOP OF ANY HYDRANT IS TO BE NO MORE THAN 200mm BELOW COVER LEVEL.
  4. ALL HYDRANTS ARE TO BE MARKED IN ACCORDANCE WITH BS 3251 (ALL COVERS SHALL BE PAINTED YELLOW WITH ROAD MARKING PAINT AND WITH A UNIQUE IDENTIFICATION NUMBER ON THE UNDERSIDE).
  5. ALL AIR VALVE AND HYDRANT COVERS LOCATED IN GRASSED AREAS TO BE SURROUNDED BY A CONCRETE PLINTH, 200mm ALL AROUND AND 100mm DEEP FORMED IN C20/25 CONCRETE, 20mm AGGREGATE SIZE AND BEDDED IN CLAUSE 804 MATERIAL. THE PLINTH SHALL INCORPORATE MILD STEEL REINFORCEMENT AND HAVE A BULL-NOSED FINISH ALL AROUND ITS EXTERNAL PERIMETER.

**LEGEND:**

EXISTING WATERMAIN

PROPOSED WATERMAIN (225 OD PE100 SDR11 PIPE) MATERIALS MUST BE IN ACCORDANCE WITH IRISH WATER STANDARDS

PROPOSED WATERMAIN (180 OD PE100 SDR11 PIPE) MATERIALS MUST BE IN ACCORDANCE WITH IRISH WATER STANDARDS

PROPOSED WATERMAIN (110 OD PE100 SDR11 PIPE) MATERIALS MUST BE IN ACCORDANCE WITH IRISH WATER STANDARDS

WATER SERVICE CONNECTION AND BOUNDARY BOX TO IRISH WATER DETAIL STD-W-26G. SERVICE PIPES TO BE DN25

WATER SERVICE CONNECTION AND BOUNDARY BOX TO IRISH WATER DETAIL STD-W-26G. SERVICE PIPE TO BE DN32 FOR LENGTHS OVER 15m & UNDER 30m

PROPOSED FIRE HYDRANT

PROPOSED AIR VALVE

PROPOSED SCOUR VALVE. SCOUR VALVE TO CONNECT TO NEARBY SURFACE WATER MANHOLE IN ACCORDANCE WITH STD-W-30A

PROPOSED SLUICE VALVE

PROPOSED SLUICE VALMECHANICAL WATERMETER & CHAMBER TO IRISH WATER DETAIL STD-W-26A. KIOSK REQUIRED TO IW DETAIL STD-W-36. KIOSK LOCATION TO BE AGREED WITH ARCHITECT

EXTENT OF PROPOSED DEVELOPMENT

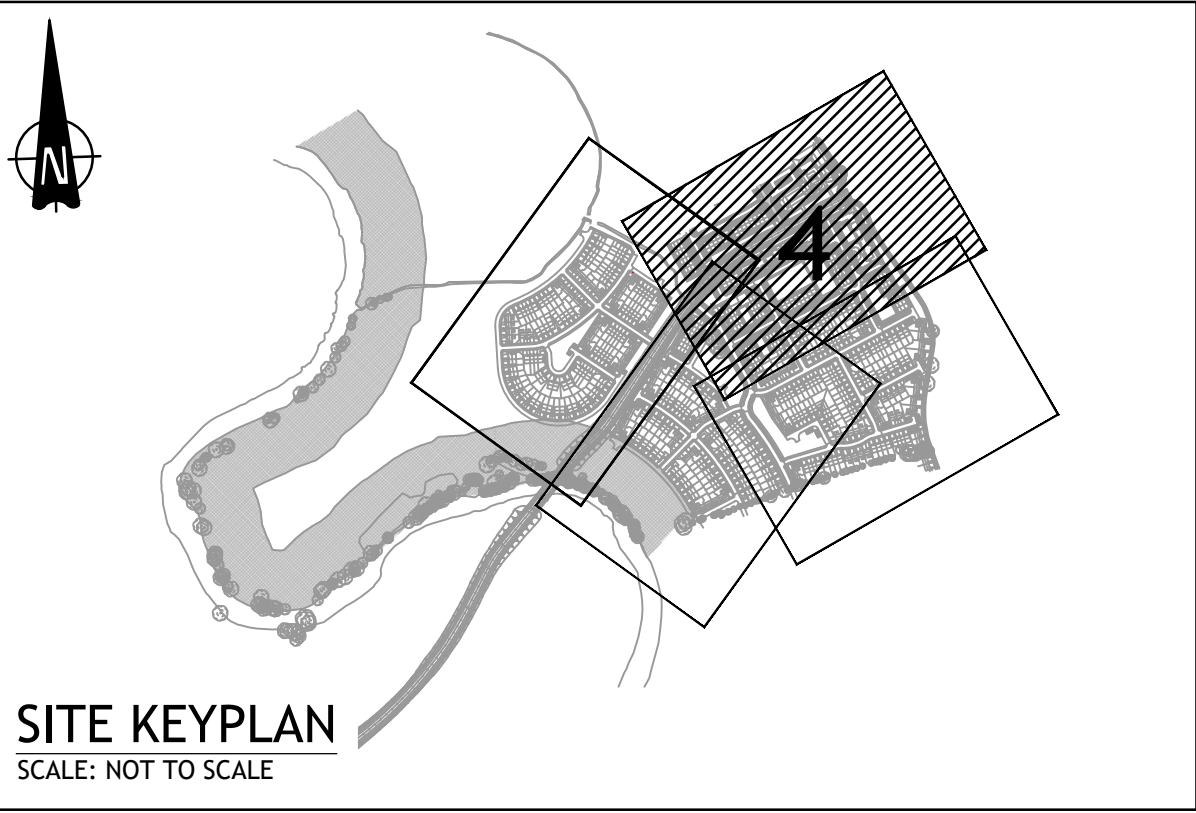

© PUNCH Consulting Engineers  
This drawing and any design hereon is the copyright of the Consultants and must not be reproduced without their written consent.  
All drawings remain the property of their Consultants.  
Figured dimension only to be taken from this drawing.  
Consultants to be informed immediately of any discrepancies before work proceeds.



Rev	Amendment	By	Date	Rev	Amendment	By	Date
C01	ISSUED FOR PLANNING	IBS	2021-09-03				
C02	ISSUED TO IW FOR SODA	IBS	2022-03-22				
C03	ISSUED TO IW FOR SODA	IBS	2022-03-28				
C04	ISSUED TO IW FOR SODA	IBS	2022-03-31				

Rev	Amendment	By	Date	Rev	Amendment	By	Date

Client:



GREAT CONNELL SHD, NEWBRIDGE				
Title: PROPOSED WATERMAIN LAYOUT - SHEET 4				
Drawn: IBS	Date drawn: AUGUST 2021	Technician Check: PJM	Engineer Check: ET	Approved: LB
Project No: 192229	Model Ref: 192229-PUNCH-XX-XX-M2-C-0301	Drawing Status: A0 PLANNING		
Scale @ A1: 1:500	Document No: 192229-PUNCH-XX-XX-DR-C-0304	Revision No: C04		